

ADATTATORI



RONDELLE BONDED



INNESTI RAPIDI



VALVOLE A SFERA

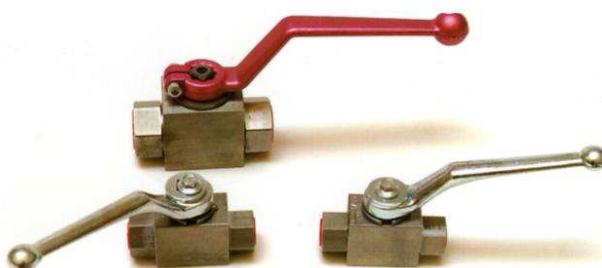

RACCORDI TUBO RIGIDO DIN 2353



ADATTATORI JIC 74°

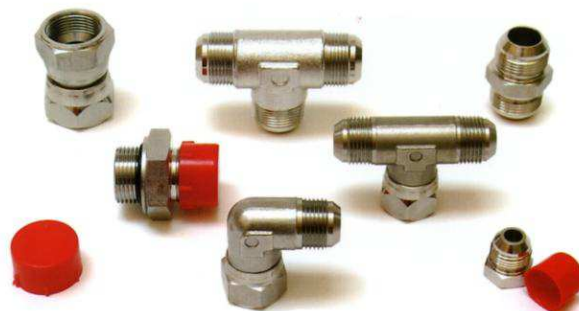

FLANGE SAE



RACCORDI A SALDARE



CAMLOCK



ADATTATORI BASSA PRESSIONE



ADATTATORI/NIPPLES INOX AISI 316

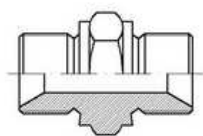

NIPPLLO M - M CILINDRICO BSP CONO 60°

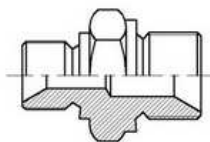

NIPPLLO RID. M - M CILINDRICO BSP CONO 60°

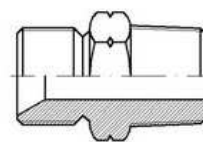

NIPPLLO M - M CIL. BSP 60°- NPT

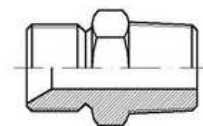

NIPPLLO M - M CIL. BSP 60°- CONICO

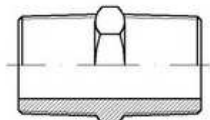

NIPPLLO M - M CONICO

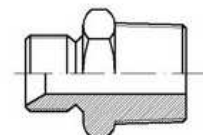

NIPPLLO RID. M - M CIL. BSP 60°- CONICO

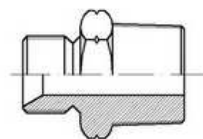

NIPPLLO RID. M - M CIL. BSP 60°- NPT

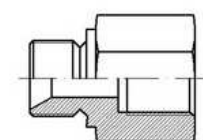

PROLUNGA M - F CIL. BSP 60°

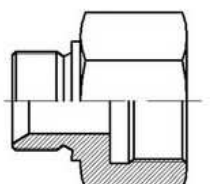

PROLUNGA RID. M - F CIL. BSP 60°

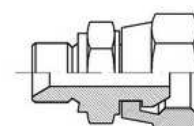

ADATTATORE RID. M - F.GIR CIL BSP 60°

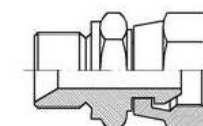

ADATTATORE M - F.GIR CIL BSP 60°

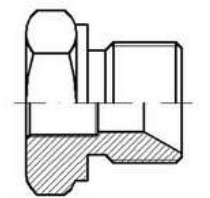

TAPPO RID. M - F CIL BSP 60°

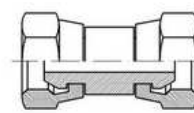

ADATTATORE F.GIR - F.GIR. CIL BSP 60°

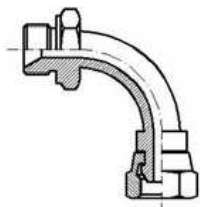

ADATTATORE 90° M - F.GIR BSP 60°

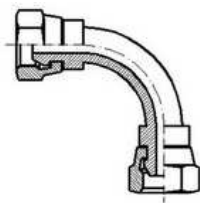

ADATTATORE 90° F.GIR. - F.GIR. BSP 60°



ADATTATORE 45° M - F.GIR BSP 60°

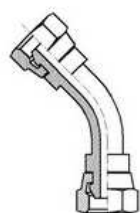

ADATTATORE 45° F.GIR. - F.GIR. BSP 60°

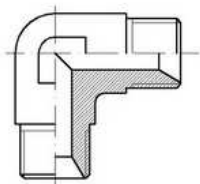

GOMITO M - M CIL. BSP 60°

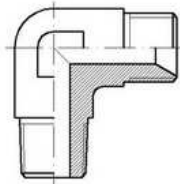

GOMITO M - M CIL. BSP 60° - CONICO

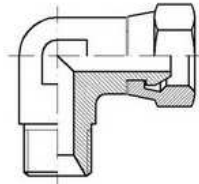

GOMITO M - F.GIR. CIL BSP 60°

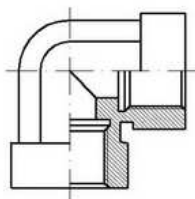

GOMITO F - F BSP

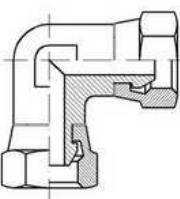

GOMITO F.GIR. - F.GIR. BSP 60°

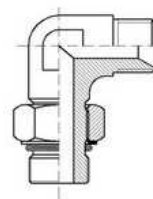

GOMITO M - M ORIENT. BSP

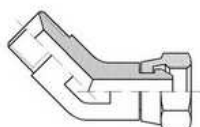

GOMITO 45° M - F.GIR. BSP 60°

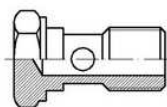

BULLONE FORATO GAS CIL. BSP

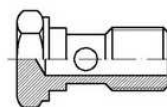

BULLONE FORATO METRICO

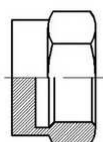

TAPPO FEMMINA FISSA BSP

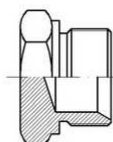

TAPPO MASCHIO ESAGONALE BSP 60°

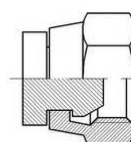

TAPPO FEMMINA GIR. BSP 60°

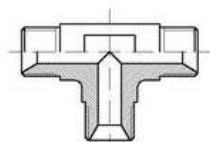

RACCORDO 3 VIE M+M+M BSP 60°

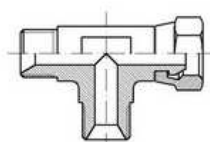

RACCORDO 3 VIE M+M+F.GIR. BSP 60°

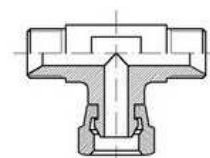

RACCORDO 3 VIE M+F.GIR.+M BSP 60°

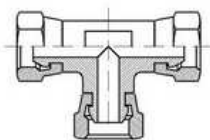

RACCORDO 3 VIE F.GIR.+F.GIR.+F.GIR. BSP

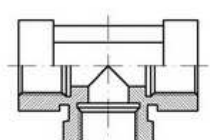

RACCORDO 3 VIE F+F+F BSP

Rubinetti a sfera a due vie in acciaio al carbonio o inox 316 L Two-way ball valves in carbon steel or stainless steel aisi 316 L



Tipo / Type GM/GMX

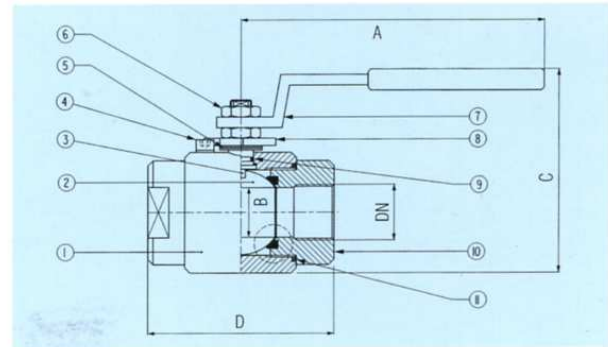

- | | | |
|-------------|--------------------|--------------------------|
| 1) Corpo | 5) Vite di fermo | 9) Ranella sagomata |
| 2) Raccordo | 6) Ranella-molla | 10) Guarnizione perno |
| 3) Sfera | 7) Dado | 11) Guarnizione raccordo |
| 4) Perno | 8) Leva di manovra | |
-
- | | | |
|-----------------|------------------|-----------------------|
| 1) Body | 5) Set-screw | 9) Profiled washer |
| 2) Pipe fitting | 6) Washer-spring | 10) Stem seal |
| 3) Ball | 7) Nut | 11) Pipe fitting seal |
| 4) Stem | 8) Handle | |

Tipo GM

- corpo e raccordi, in acciaio A 105
- zincatura colore argento
- perno e sfera, in AISI 316 L

Guarnizioni standard

- sfera: POM mos 2
- perno: PTFE
- raccordo: PTFE + BUNA

Tipo GMX

- corpo, raccordi, perno e sfera in AISI 316 L

Maniglia di manovra

- acciaio zincato e plastificato blu

Type GM

- Body and pipe fittings are in steel A 105
- Silver zinc plated surface
- Stem and ball are in AISI 316 L

Standard seals

- Ball: POM mos 2
- Stem: PTFE
- Connection: PTFE + BUNA

Type GMX

- Body, pipe fittings stem and ball are in AISI 316 L

Handle

- Zinc plated steel with blue plastic sleeve

A richiesta: materiali, guarnizioni e filettature differenti. On request: different materials, seals and threads.

TIPO /TYPE	PN	DN	A	B	C	D	KG	TIPO /TYPE
GM 1/4"	500	8	142	10	80	65	0,70	GMX 1/4"
GM 3/8"	500	10	142	10	80	65	0,65	GMX 3/8"
GM 1/2"	500	15	142	15	86	73	0,95	GMX 1/2"
GM 3/4"	400	20	180	19	95	90	1,60	GMX 3/4"
GM 1"	350	25	180	24	105	98	2,45	GMX 1"
GM 1 1/4"	350	32	280	32	112	115	2,53	GMX 1 1/4"
GM 1 1/2"	350	40	280	38	135	125	4,70	GMX 1 1/2"
GM 2"	350	50	280	48	153	154	7,00	GMX 2"
GM 2 1/2"	150	65	380	65	162	160	13,50	GMX 2 1/2"
GM 3"	100	80	380	77	197	197	23,50	GMX 3"
GM 4"	50	100	380	95	230	225	35,00	GMX 4"